

G1K653 AND G1K657 AUGER SPINDLE AND COUPLER KIT INSTALLATION INSTRUCTIONS

1050 Grain Cart and Corner Auger Grain Carts



KINZE®

G1K653 AND G1K657 AUGER SPINDLE AND COUPLER KIT INSTALLATION INSTRUCTIONS

(1050 Grain Cart and Corner Auger Grain Carts)

IS865

Rev. 6/18

Read completely through these instructions before starting installation.

Make sure you have all parts needed to complete installation using components listing at end of these instructions.

Information in these instructions was current at time of printing. However, due to Kinze's ongoing product improvement, production changes may cause your machine to appear slightly different in detail. Kinze Manufacturing, Inc. reserves the right to change specifications or design without notice and without incurring obligation to install the same on machines previously manufactured.

Right hand (R.H.) and left hand (L.H.) used throughout these instructions are determined by facing direction machine travels in use, unless otherwise stated.

Throughout this instruction the symbol  and the words **DANGER**, **WARNING**, and **CAUTION** are used to call attention to safety information that if not followed, will or could result in death or injury. **NOTICE** and **NOTE** are used to call your attention to important information. The definition of each of these terms follows:



Indicates an imminently hazardous situation that, if not avoided, will result in death or serious injury. This signal word is to be limited to the most extreme situations, typically for machine components which, for functional purposes, cannot be guarded.



Indicates a potentially hazardous situation that, if not avoided, could result in death or serious injury, and includes hazards that are exposed when guards are removed. It may also be used to alert against unsafe practices.



Indicates a potentially hazardous situation that, if not avoided, may result in minor or moderate injury. It may also be used to alert against unsafe practices.

NOTICE

Used to address safety practices not related to personal injury.

NOTE: Special point of information or machine adjustment instructions.

**DANGER**

Falling grain auger cart can crush and will cause death or serious injury. Never work around or under cart when raised without installing blocks to support cart. Use care when removing and installing components to prevent pulling or pushing cart off axles.

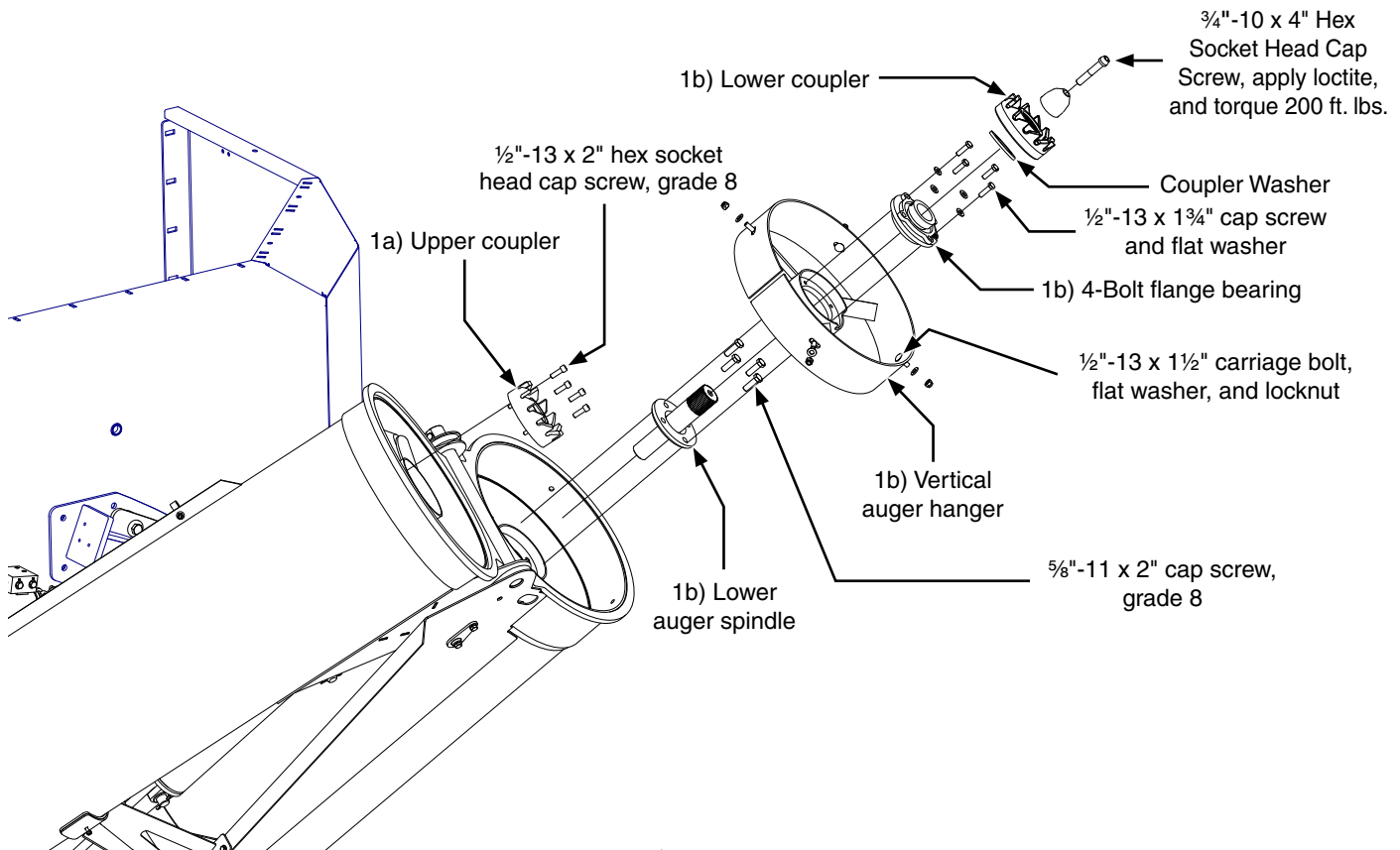

Step 1. Remove existing auger pivot pin and hardware.

Use the above illustration for reference.

1a) Upper Vertical Auger

Remove existing upper coupler and install new coupler with grade 8, 1/2"-13 x 1 1/2" hex socket head cap screws and use loctite 243.

1b) Lower Vertical Auger

Remove existing lower auger spindle, vertical auger hanger, 4-bolt flange bearing, coupler washer, lower coupler, and hardware.

Install new lower auger spindle, apply loctite 243 and secure with grade 8, 5/8"-11 x 2" cap screws.

Install 4-bolt flange bearing into vertical auger hanger with 1/2"-13 x 1 3/4" cap screw and flat washer using loctite 243.

Install vertical auger hanger and bearing assembly and secure with 1/2"-13 x 1 1/2" carriage bolt, flat washer, and locknut.

Install lower coupler using 3/4"-10 x 4" Hex Socket Head Cap Screw and loctite 243. Torque to 200 ft./lbs.

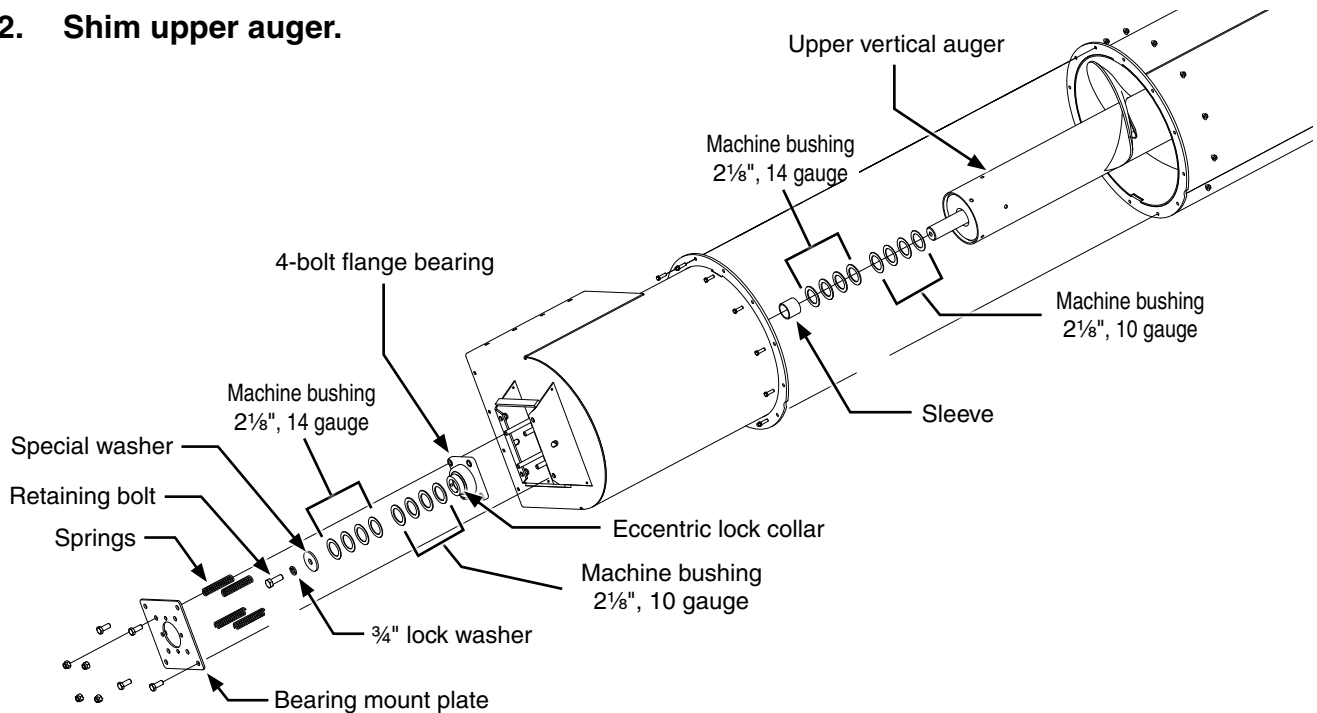
Step 2. Shim upper auger.

- a. Unfold auger to field position and remove bearing mount plate.
- b. Loosen eccentric lock collar on 4-bolt flange bearing.
- c. Loosen retaining bolt on auger spindle to allow upper auger to seat against lower auger.
- d. Inside of spout, measure gap between sleeve and bottom of bearing.

**DANGER**

Falling auger can crush and will cause death or serious injury. Tighten retaining bolt before unfolding auger.

- e. Tighten retaining bolt and fold auger so it is horizontal to the ground.
- f. Remove retaining bolt and slide auger away from bearing. Add or remove shims as required under sleeve for the amount of gap measured in Step 2d.
- g. Slide auger back through bearing. Install shims until gap between top shim and special washer is flush or less than 1/16".
- h. Install 3/4" lock washer and retaining bolt.
- i. Reinstall lock collar and bearing mount plate.

1K657 Auger Spindle and Coupler Kit (1050/900)

- (4)10039 Hex Head Cap Screw, ½"-13 x 1¾"
- (4)11389 Flat Washer, ½" Plated SAE
- (4)11559 Hex Socket Head Cap Screw, ½"-13 x 1½"
- (4)11174 Hex Head Cap Screw, ⅝"-11 x 2"
- (4)10636 Carriage Bolt, ½"-13 x 1½"
- (4)10111 Lock Nut, ½"-13
- (3)10234 Machine Bushing, 2⅛", 10 Gauge (.1345")
- (3)10336 Machine Bushing, 2⅛", 14 Gauge (.0747")
- (1)D25419 Hex Socket Head Cap Screw,
¾"-10 x 4", Grade 5
- (1)D29793 Upper Coupler
- (1)D29312 Coupler Washer
- (1)D29792 Lower Coupler
- (1)D26892 Vertical Pilot Cone
- (1)A18487 Lower Auger Spindle
- (1)A18517 4-Bolt Piloted Flange Bearing, 27/16"
- (1)A18488 Vertical Auger Hanger
- (1)IS865 Instruction Sheet

1K653 Auger Spindle and Coupler Kit (1100/1300/1500)

- (4)10039 Hex Head Cap Screw, ½"-13 x 1¾"
- (4)11389 Flat Washer, ½" Plated SAE
- (4)11174 Hex Head Cap Screw, ⅝"-11 x 2"
- (4)10636 Carriage Bolt, ½"-13 x 1½"
- (4)10111 Lock Nut, ½"-13
- (3)10234 Machine Bushing, 2⅛", 10 Gauge (.1345")
- (3)10336 Machine Bushing, 2⅛", 14 Gauge (.0747")
- (4)11587 Hex Socket Head Cap Screw, ½"-13 x 2"
- (1)D25419 Hex Socket Head Cap Screw,
¾"-10 x 4", Grade 5
- (1)D29793 Upper Coupler
- (1)D29312 Coupler Washer
- (1)D29792 Lower Coupler
- (1)D26892 Vertical Pilot Cone
- (1)A18487 Lower Auger Spindle
- (1)A18517 4-Bolt Piloted Flange Bearing, 27/16"
- (1)A18392 Vertical Auger Hanger
- (1)IS865 Instruction Sheet

Kinze Manufacturing, Inc.

I-80 at Exit 216 North, Williamsburg, Iowa 52361

Kinze® and the Kinze® logo are trademarks owned by Kinze Manufacturing, Inc.